

## The garden of humours

### The proper use of plants

The garden rounds off the discovery trail devoted to medieval gastronomy. Twelve box tree squares present 150 species of herbs well known in the Middle Ages, here arranged according to their use as food (herbs, roots, etc), in medicine (antidotes, panacea, women's remedies, etc) and in the home (dyes, textiles, etc). All culinary herbs were also considered to have medicinal powers. The "theory of the four humours" formulated by Galen and Hippocrates\* back in Ancient times also recommended a balanced diet as a means of staying healthy.

### Cooking and health

People used to believe that there were four main temperaments (choleric, sanguine, phlegmatic and melancholic) derived from the four elements and the four humours (yellow bile, blood, phlegm and black bile) secreted by the body. Galen argued that illness was caused by a surplus of one humour, leading to an internal imbalance. Thus balance had to be restored to restore health. An excess of phlegm (a cold for example) was treated by eating hot and dry foods (spices, roasted meats etc). Labels indicate which herbs are good for choleric (red), sanguine (yellow), melancholic (mauve), and phlegmatic (blue) temperaments.

\* *Explanations overleaf.*

## Glossary

**In-built staircase:** built into the main body of the building.

**Out-built staircase:** projecting out from the main body of the building.

**Hippocrates:** Greek doctor (born circa 460BC, died circa 377 BC) considered as one of the fathers of medicine, like Claude Galen, who was also Greek (131-201 AD).

**Lintel:** horizontal beam or stone that holds up the wall over a window, a door, etc.

**Rib:** or ogive, a diagonal rib that consolidates and supports an arch.

**Tracery:** all fixed components dividing a window.

## Practical information

Visit takes on average: one and a half hours.

Guided tours.

Special tours for disabled people.



The Centre des monuments nationaux publishes a collection of guidebooks about French monuments, translated into several languages. Éditions du patrimoine publications are on sale in the bookshop-giftshop.

Centre des monuments nationaux  
Château de Châteaudun  
28200 Châteaudun  
tél. 02 37 94 02 90  
fax 02 37 94 02 94

[www.monuments-nationaux.fr](http://www.monuments-nationaux.fr)

# Châteaudun Castle

A castle in the land of the Dunois

## Residence of the "Bastard of Orleans"

Following the Norman invasions of 910, Thibaut I, or Thibaut the Cheat, Count of Blois, had a fortress built in Châteaudun, to which his descendent added an impressive keep in the



12th century. In 1391, the counties of Blois and Dunois were bought by Louis of Orleans, brother of the King of France,

Charles VI. In 1439, his son gave them to his half-brother John, known as the "Bastard of Orleans" or "Dunois", companion in arms to Joan of Arc. In 1452 he began to convert the castle, adding a Holy Chapel. This work was continued by his descendants, the Dukes of Longueville.

## Ill-treated by History

When the Longueville family died out in 1694, the castle was left to the Dukes of Luynes. Semi-abandoned, in 1723 it housed the victims of a fire that swept through the town. During the Revolution, the damaged building's chapel was sacked and its living area converted into a barracks. The castle was again mistreated by the Prussians in 1870. In 1938 it was acquired by the State and restored by the architect Jean Trouvelot.

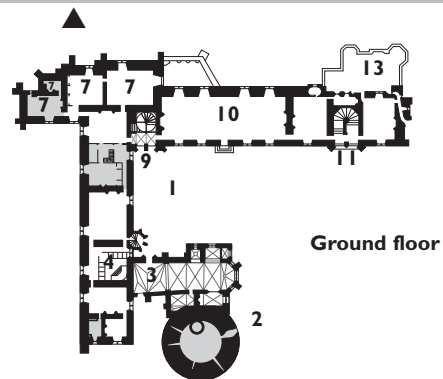

Ground floor

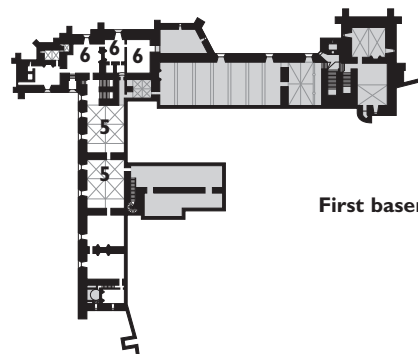

First basement

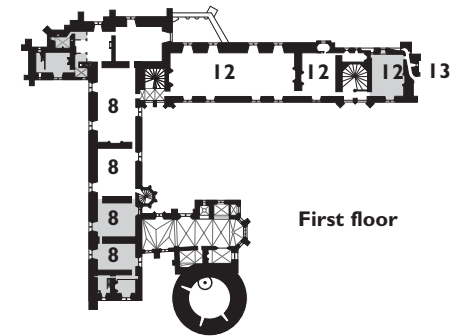

First floor

## Four centuries of architecture

Built on a rocky outcrop, Châteaudun castle stands in a strategic position, on an ideal defensive site between Beauce and Perche.

- 1 The main courtyard** has three spiral staircases illustrating the architectural developments made as the Renaissance drew near. The first, dating back to the 1460s, is in an out-built\* polygonal tower, in the traditional French style. The other two are in-built\* and notable for their loggia façades. The first, near the Dunois wing, dates back to the 1470s and is a masterpiece of High Gothic style. At the other end of the wing, the second staircase from the early 16th century retains a Gothic style with its assertive sheerness and sculpted exterior, while inside hosting a more Italianising decor.
- 2 The cylindrical keep** is a typical example of 12th-century military architecture, with three floors and standing 31 metres high. It was originally entered through a door 10 metres off the ground, which today gives onto the chapel loft. It can be visited as part of a guided tour.
- 3 The chapel**, built between 1451 and 1493, was raised to the status of Holy Chapel by the Pope in 1468. The lower chapel consists of a chancel into which daylight streams through large openwork windows with small columns, and a three-quarter rib-vaulted\* nave. Its windows are adorned with flamboyant tracery\*. Until the Revolution, the Holy Chapel held a relic of Christ's Passion:

a piece of wood from the Holy Cross, which Dunois received from Charles VII. All that remains of the original rich decor is a set of fifteen statues from the 15th-century Loire workshops depicting the saints to which Dunois and his family were especially devoted. A fresco dated 1468 depicts the Final Judgement.

## The Dunois Wing

This wing, built between 1459 and 1468, incorporates five floors to offset the uneven nature of the land.

- 4 The justice hall** is a rare example of Ancien Régime jurisdiction to have preserved its 17th-century decoration. It was used as a revolutionary court in 1793.
- 5 The medieval kitchens** in the basement are especially well preserved. Their ribbed vaults finish on two massive fireplaces.
- 6 The prisons**, on the same floor, have several cells.
- 7 The north dwelling**, on the ground floor, consists of several rooms, one of which is adorned with crowned lilies and Ls, commemorating Louis XIV's visits to the castle in 1682 and 1685. Next door, the panelled room was used as a dining hall by the castle's last owners, the Dukes of Luynes.
- 8 Jean Dunois's dwelling** is on the first floor.

- 9 The large Gothic staircase** is reminiscent of the famous "spiral" built for Charles V in the Louvre. At the top, the dormer windows are adorned with fleur-de-lis, reminding us that the castle's owner is a descendant of Charles V.

## The Longueville wing

The Longueville wing was built from 1510 onwards by François II of Longueville, grandson of Dunois. The rich decor on its façade, especially on the cornice, reveals "classical" elements, precursors of the Renaissance.

- 10 The large lower hall** covering 300 m<sup>2</sup> has two fireplaces, over one of which is a stag "at rest".
- 11** The interior of the **large Renaissance staircase** is decorated with Italianising patterns on the landing door lintels\*, on the capitals and on the console figures.
- 12 Catherine of Alençon's apartments**, on the upper floor, show a set of tapestries recounting the life of Moses.

## The terrace

- 13 The terrace.** Site where a bedchamber, chapel and study, which collapsed in the 18th century, used to stand.